



MASTER PLAN



www.GMNC.org / grandmesanordic@gmail.com

Business Office: PO Box 4034, Grand Junction CO 81501



Submitted By: _____ Date: 5 October 2020
Joe Ramey GMNC President

Reviewed By: _____ Date: _____
Ryan Fricke
Recreation Specialist
Grand Valley RD

Reviewed By: _____ Date: _____
Kamran Mousavi
Acting Recreation Staff
Grand Valley RD

Reviewed By: _____ Date: _____
Bill Edwards
District Ranger
Grand Valley RD

Approved by: _____ Date: _____
Chad Stewart
GMUG Forest Supervisor

Table of Contents

I.	Introduction and Mission Statement	4
II.	History	5
III.	Existing Trailheads	6
	• Skyway Trails	7
	• County Line and Ward Lake Trails	8
IV.	Funding	9
V.	Community Outreach, Other Regional Nordic Trails	10
VI.	Goals and Objectives	11
	• GMNC Organization: Objectives, Core Competencies, Financial Objectives	11
	• Permits, Annual Operating Plan	12
	• Community Presence: Programs & Events, Marketing	12-13
	• Current Trends: Trail Safety, Parking, Grooming Equipment	13-14
	• Snowcat Capital Replacement Fund, Signage & Map	14
	• USFS Permits, Trail Facilities: Proposed Maintenance Shed, Proposed Skyway Hut, Proposed County Line Lodge	15-16
VII.	Goals and Priorities Chart	17-18
VIII.	Exhibits	
	• Exhibit-A: Skyway & County Line & Ward Trail Maps	19
	• Exhibit-B: GMNC Annual Budget and Expenditures	20
	• Exhibit-C: Proposed Skyway Warming Hut	21-23
	• Exhibit-D: Proposed Ungroomed Snowshoe Trail	24

www.GMNC.org / grandmesanordic@gmail.com

Business Office: PO Box 4034, Grand Junction CO 81501



Introduction and Mission Statement

This **Master Plan** is intended to guide the management, development and future of the Grand Mesa Nordic Council (GMNC), ensuring that the trails and programs of the GMNC continue to provide a high-quality skiing experience for the GMNC members and the public. It is based on direction from the Board of Directors and input from the staff, the membership and the public upon acceptance from the US Forest Service. It addresses the following mission statement of the organization:

“Grand Mesa Nordic Council is a community-supported, nonprofit organization of people who love to cross-country ski on the Grand Mesa in western Colorado. We are dedicated to promoting fun, safe, cross-country skiing experiences for skiers of all ages and abilities.”

GMNC pursues its mission through the maintenance and development of public winter recreational trails and facilities, cross-country ski races, and associated educational events. In order to ensure the fulfillment of this vision, GMNC is dedicated to working with our partners: the U.S. Forest Service, The Nature Connection, Delta and Mesa Counties, local School Districts, and volunteers to provide high quality, safe and affordable winter recreational opportunities to the public.

This Master Plan provides direction with goals for implementing the plan. To remain viable and current, the Master Plan must be flexible and dynamic with a focus on the sustainability of the GMNC programs and operations. To this end it will be reviewed annually in May and fully reevaluated at least every five years or the expiration of the term of special use permit.

The Board of Directors will develop a specific annual Operating Plan with associated action items. The Operating Plan will be based on the stated goals and plans for implementation of the Master Plan.

The GMNC is committed to being a responsible member of the area community. These goals and the annual Work Plan action items will be pursued legally, ethically and with appropriate concern for our environment.

www.GMNC.org / grandmesanordic@gmail.com

Business Office: PO Box 4034, Grand Junction CO 81501

History

Developed Nordic skiing trails have been in existence on the Grand Mesa since the mid-1980s. The first snowmobile-groomed trails were developed by the USFS at County Line. Trails were often groomed by dragging an old bedspring behind a snowmobile before tracksetters were used. Cross-country skiers have utilized the Ward Lake trails since the late 1980s.

The Grand Mesa Nordic Council (GMNC) was founded in March 1990. GMNC was organized for charitable and educational purposes and to encourage public participation in the sport of cross-country skiing in Mesa and Delta Counties. In 1991, the IRS issued a determination letter that recognized GMNC as a tax exempt organization under section 501(c)(3) of the Internal Revenue Code.

Machine grooming of the Ward Lake trails began in January 1991. When skate skiing became widely popular in the early 1990s, Nordic enthusiasts required wider and more thoroughly groomed trails.

Initially the GMNC was permitted by the USFS to groom the Ward Lake trails under an events permit. Eventually, the GMNC was allowed to utilize the Skyway and County Line trailheads for additional ski trails as the demand for groomed cross-country ski trails increased. By the 2002-03 season the GMNC had grown to 30 kilometers of trails and paid groomers.

Every year the region's trail conditions have improved because of better trail alignments, pre-season trail preparation, use of more technical and more appropriate grooming equipment, more skillful equipment operators and committed volunteers and staff.



**GMNC founding members
January 2020. From left to
right: Anita Evans,
Winslow Robertson,
Tom Ela, Charles Bodie,
and Richard Hypio.**

Photo by Seth Anderson.

www.GMNC.org / grandmesanordic@gmail.com

Business Office: PO Box 4034, Grand Junction CO 81501

Existing Trailheads

There are three separate ski trail systems that comprise the groomed Nordic skiing on the Grand Mesa and associated facilities available to the public within a one hour drive from the Grand Junction, Montrose, and the Delta County communities. Skyway and County Line trail systems are connected by two different trails.

See **EXHIBIT- A** for the Overall Maps of GMNC trail systems.

- Skyway Trails - GMNC
- County Line Trails - two trail entrances - GMNC
- Ward Lake Trails – GMNC

All ski trails are within the Grand Mesa/Gunnison/Uncompahgre National Forest (GMUG) and located on top of the Grand Mesa. The GMNC holds a USFS Special Use Permit to allow for grooming, as well as events and ski lessons. Season memberships are available for individuals, families and businesses, all in support of the trail system. Memberships are the largest source of funds for the trail system. All trails are operated as “No Fee” and a \$10 donation per adult is recommended.

Due to an elevation over 10,500 feet, Skyway and County Line typically receive early skiable snow compared to other Nordic areas in the state and region. Nordic ski teams and enthusiasts often look to the GMNC trails for their first seasonal opportunities to ski.

Estimating skier visits is not easy. To that end, the GMNC has conducted vehicle counts both on weekdays and weekends. Skier visits have clearly increased due to the quality of grooming, the increased popularity of cross-country skiing, and population growth of the greater Grand Mesa region.

Current GMNC membership is between 500-600 paid members.

Estimates of skier visits are around 1500/week.

With a core season of 20 weeks, that represents 30,000 skier visits annually.

The GMNC offers adult lesson programs, clinics for advanced skiers, instructor clinics and events. In the past, the GMNC sponsored a popular youth program and intends to have a youth program in the near future.

www.GMNC.org / grandmesanordic@gmail.com

Business Office: PO Box 4034, Grand Junction CO 81501

Skyway Trailhead

The Skyway Ski Trails are located on the top of Grand Mesa and are all within Mesa County. GMNC, under a permit with the USFS, grooms and maintains these trails. Mapping signs, trail etiquette signs, and donation box are located at the trailhead. The 21.6 kilometers of trail includes a small Practice Loop maintained for a lesson area. The trails are generally rated as easy to intermediate, but skiers of all levels use them.

The Skyway parking lot was enlarged in 2018 to accommodate up to 80 vehicles. Two vault toilets were installed at the same time.

A 12'x12' soft-sided temporary warming hut has been in place since 2009 near the Skyway trailhead from November through May.

The trailhead and Skyway parking lot are located at the intersection of the Scales Lake Road, USFS Road 118, and Highway 65. The USFS currently allows motorized vehicles to use USFS Road 118 until November 15. If the roadbed is driven on in saturated conditions it can suffer deep ruts which can significantly increase the work and amount of snow required to establish a properly groomed trail for Nordic skiing.

During early season, grooming is accomplished primarily with snowmobiles pulling roller and Ginzu Groomer™ attachments. GMNC transports its PistenBully 400 snowcat to Skyway after the first significant storms for grooming for the season. The snowcat often has to be plugged into a generator during cold weather periods prior to starting. There is no shelter or storage for grooming equipment. The grooming operators are a combination of GMNC paid staff and member volunteers.

These are multi-use trails, on which the USFS allows snowshoeing, foot traffic and skiers with dogs. The USFS allows signage to recommend other areas to ski with dogs and to discourage hiking on the trails. Dogs and hiking creates significant trail damage and raises safety concerns as hikers post-hole on the groomed trails.

GMNC mission is to provide safe skiing for everyone and to limit user friction, the GMNC has kept Skyway dog-free, as per member consensus. Due to the many hills and trail intersections, dog confrontations are more likely to occur on the Skyway trails. In the name of safety, it is recommended that dog owners use County Line or Ward trails instead, as skier safety is the top priority of the GMNC. With the growth of performance-oriented skiing, Skyway has evolved as the destination for those skiers. Since 1994, dogs have been discouraged at Skyway, and continue to be an ongoing management issue for GMNC.

See **EXHIBIT-A** for the Overall Maps of GMNC trail systems.

www.GMNC.org / grandmesanordic@gmail.com

Business Office: PO Box 4034, Grand Junction CO 81501

County Line Trailhead

The County Line trails are located entirely on National Forest lands. The trailhead is located along Highway 65 at the Mesa County and Delta County line. The parking lot and toilets at the trailhead were upgraded in approximately 2014.

The County Line trailhead has mapping signs, a donation box, dog-use sign, and a skier etiquette sign. The 15.7 kilometers of trails are rated for beginner and intermediate skiers. They are groomed and maintained under a Special Use Permit with the USFS.

Grooming is accomplished using snowmobiles with roller and Ginzu Groomer™ attachments and the GMNC snowcat. The snowmobiles and snowcat are parked at Skyway, and the County Line system is groomed using the connector trails, Scales Lake Road and Kannah Crossing.

The Nature Connection uses these trails to conduct their on-snow classroom and activities, as the terrain is better for beginners. (The Nature Connection is the hub of outdoor recreation and education for Delta County and Olathe, supported by the Delta County School District, The Great Outdoors Colorado and the Generation Wild Initiative.)

These are multi-use trails, which in addition to Nordic skiing also allow snowshoers, with the proper trail etiquette to discourage damaging the trails. Foot traffic without snowshoes is discouraged for safety reasons and creates deep holes that damage groomed trails. More signs are needed to discourage foot traffic without snowshoes. A separate, ungroomed trail for snowshoers is recommended by the Council. **See Exhibit - D.**

Skiers with dogs are encouraged to ski at County Line. A second entrance was created in the fall of 2019 to relieve trailhead congestion and conflict. Dogs are an issue at County Line for two reasons: safety and sanitation. Collisions and confrontations with skiers do occur regularly on the trails and in the parking lot. Not all owners clean up debris and excrement left behind by their dogs. Dog poop bags are not supplied at the trailhead, as per USFS recommendation. When dog bags were available at the trailhead, they were often left behind on the trail creating more of a mess.

Ward Lake Trailhead

The Ward Lake trails are 100% within Delta County and offer backcountry skiing for GMNC users. The trails consist of one 7 KM groomed trail that runs from the Upper Ward Lake campground on Barron Lake Drive to the lower Ward Creek reservoir. Numerous ungroomed backcountry trails are located within the system, with a total of 18 km of marked and signed trails, accessed from the main Ward trail. Grooming is done with a snowmobile and roller/grader and Ginzu Groomer™. The main Ward trailhead is located at the lower Ward Creek reservoir, as there is limited parking along Barron Lake Drive. In recent seasons there has been a marked increase in snowmobile intrusions into the ski area, mainly along the southeast portion of the trail system across the Skinned Horse trail. Additional 'No Snowmobile' signs there may help. See **EXHIBIT-A** for the Overall Maps of GMNC trail systems.

www.GMNC.org / grandmesanordic@gmail.com

Business Office: PO Box 4034, Grand Junction CO 81501

Funding

The majority of funds raised and/or otherwise generated by GMNC are used to cover costs associated with trail grooming and maintenance, which are substantial. Ski Area Operations includes: grooming equipment, maintenance (winter and summer), fuel, paid groomers and trail supplies. The grooming operators are a combination of GMNC paid staff and GMNC volunteers.

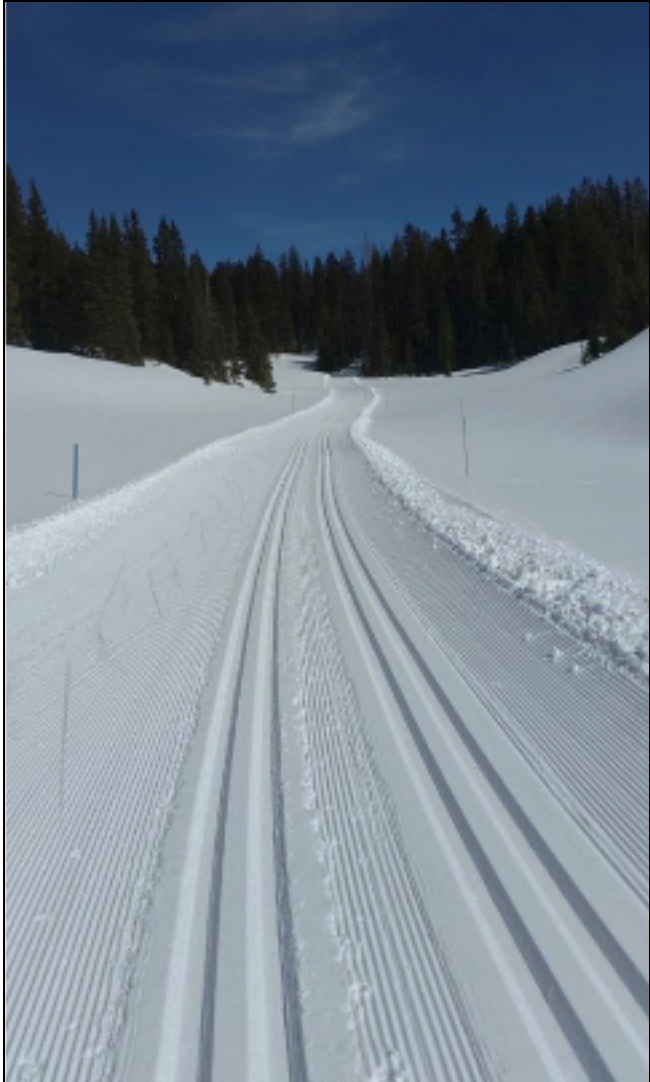

Donations from individuals, businesses and trailhead donation boxes average approximately \$62,000 annually (as of 2020) which covers most of GMNC's regular operating expenses. Net proceeds from the GMNC events, races and lessons, also go towards trail operations. The balance of funds required for trail maintenance come from grants and donations.

There are no trail fees at this time, although \$10 per day is suggested for all non-members of the GMNC.

The yearly expenses to groom all GMNC trails is \$72,800 using the PistenBully 400 snowcat and snowmobiles as needed. Normal ski use does not require daily grooming updates. But major trail damage is done by foot traffic without snowshoes, snowshoers, and dogs that requires more frequent grooming.

See **EXHIBIT B:** GMNC Annual Budget and Expenditures.

www.GMNC.org / grandmesanordic@gmail.com

Business Office: PO Box 4034, Grand Junction CO 81501

Community Outreach



Photo by Tamie Meck Vince Galgano and Priscilla Williams were recently selected to lead The Nature Connection in implementing its \$1.7 million Great Outdoors Colorado Inspire grant.

- GMNC works with The Nature Connection (TNC) and their winter environmental education program.
- GMNC coordinates with TNC to provide grooming for their events.
- GMNC sponsors the Colorado Mesa University Nordic race weekend and is proud to have the ski team regularly train on our trails.
- GMNC offers advisory information to other regional trail operators.
- GMNC offers early-season on-snow clinics held in November/December for all levels of Nordic enthusiasts from around the Rocky Mountain region.
- GMNC offers introductory slideshow presentations several times a season at REI.
- The GMNC website, GMNC.org, is the primary information portal for GMNC. Within the site there are grooming reports updated daily, weather forecasts and reports, calendar of events, trail maps for each trail system, donation and membership online sign-up, ski lesson sign-up, history, general and specific information about skiing.
- The GMNC Facebook page provides daily updates on events, conditions, and grooming.

Other Regional Nordic Trails

GMNC does not contribute grooming or funding to the following trail systems:

- Odin Recreation Nordic Area (at the base of Powderhorn Ski Resort)
- Mesa Lakes Lodge Trails
- The Bench Trail from Mesa Lakes to Powderhorn Ski Resort
- Trail at the top of Powderhorn Ski Resort

Goals and Objectives

GMNC ORGANIZATION:

GMNC has experienced strong growth over the last ten years. Membership income has increased to around \$55,000/year. The number of Nordic skiers has increased along with expectations for consistent, high-quality grooming. A significant portion of the total labor required to manage and maintain well-groomed trails, grooming equipment, signage, fundraising, memberships and trail permits has been provided by the volunteer Board and GMNC members.

Board members have contributed between 1000 and 2000 hours each year over the last five years. The board recognizes the amount of volunteer time is not sustainable. *There is a need for the organization to delegate a significant portion of the responsibilities to a paid operations manager/executive director position.* That will free board members to develop and maintain a strong overall organization and focus on the big picture issues described below. Current Board officers include President, Vice-President, Treasurer, and Secretary. Seasonal paid positions include Operations Manager and Membership Coordinator.

GMNC Objectives

1. Maintain a diverse committed group of board members representing a broad spectrum of this community.
2. Identify the core competencies needed to operate this organization, then assign them to board members, employees or volunteers based on their skills. Review operational tasks currently handled by board members to ascertain those tasks that would more appropriately be delegated to a paid Operations Manager.

The core competencies for GMNC are:

- a. Permitting and reporting process with the USFS
 - b. Trail management
 - c. Equipment maintenance and replacement
 - d. Financial management and membership
 - e. Public relations, promotions & marketing
 - f. Grant writing and fundraising
 - g. Events organizing
 - h. Volunteer Coordinator
3. Financial Objectives:
 - a. Provide annual budgets for the fiscal year.
 - b. Promote sound financial management.
 - c. Continue to seek funding grants for operations and equipment.
 - d. Investigate ways to expand all current sources of revenue including membership dues, event fees, government grants, private grants, and voluntary donations.
 - e. Continue the partnership with Delta and Mesa Counties for their contributions.
 - f. Develop a long-term plan to replace capital assets: snowmobiles and snowcats.

Permits

GMNC holds a Ski Trail Special Use Permit issued December 2018. This permit allows for everything the GMNC has done in prior seasons including grooming, lessons, events, huts, signs, storage, trail maintenance, fuel tank storage, and the storage container located at Skyway.

The annual operating plan is tiered off this permit that authorizes use. So, this includes the specifics and approvals (how, what, when, where).

- Ski Trail Special Use Permit expires 11/15/2028.
- The annual Operating Plan expires 10/15/2020.

ANNUAL OPERATING PLAN:

Create a pre-season annual Operating Plan to be submitted by October 15 of each year that addresses some of the goals within this Master Plan. The Operating Plan is to be more specific, describing an action plan to attain the goals for the season and to be the implementation of those goals.

Community Presence

GMNC is committed to serving as the leader and advisor of the regional Nordic community and the promotion of Nordic skiing as an integral part of the GMNC regional experience.

1. Encourage the culture of Nordic skiing to our local and regional citizens and visitors.
2. Be an available resource providing guidance to the other Nordic trail system operators and area school programs.
3. Have a paid Operations Manager for Nordic trails and events. The Operations Manager will have annual performance reviews by the GMNC Board and representatives of any other entities contributing to the manager's salary.
4. Pursue a dialog with the surrounding towns and counties focused on collaboration and marketing Nordic skiing and events in the GMNC region.
5. Continually review and update the GMNC website to reflect current information on trail conditions, lessons, and events. Promote the website as our information portal.

Programs and Events

1. Continue to promote and hold the GMNC race series and other events at either Skyway or County Line trail systems.
2. Continue to offer a variety of clinics and lessons at Skyway and County Line trail systems.
3. Restart a kid's program to introduce and sustain children's involvement in cross country skiing.

Marketing

Provide GMNC's information to regional and national publications, tourism organizations and schools.

1. Board members or paid staff shall maintain GMNC's donor database with membership

data, donations and other contacts. The contact list should be updated utilizing previous season list of members and donors, recent clinic, lesson, and event attendee lists and board knowledge of new users of Nordic trails. The contact list should be updated on a continual basis with a thorough update prior to mailing the annual fall membership drive letter. The current contact list should be stored online so that it is accessible to GMNC board members and staff.

2. Ensure the annual fall membership drive letter is mailed no later than 30th of November.
3. Utilize newsletters, postcard mailing, local media and mass-email to inform members about current events, opportunities for volunteers and issues impacting Nordic trail users. The goal of the newsletters is to encourage membership and involvement.
4. Ensure a board member or volunteer is maintaining GMNC's presence on social media sites.
5. Ensure a board member or volunteer is maintaining GMNC's website.

Current Trends

Trail Safety

GMNC promotes safety to it's employees and volunteers and members. Groomers protocol is to have a meeting at the beginning of each season to review safe grooming practices. The instructors hold a clinic at the beginning of every season to go over safety measures. GMNC members are reminded of safe practices on the Etiquette signage at the trailheads.

Signage is visible on the Skyway and County Line trails systems regarding skier etiquette and best practices for safe skiing with dogs. At Skyway there is greater usage, congestion, steeper terrain and numerous blind corners making these trails much less suited to skiing with dogs. GMNC designates specific trails at the County Line trail system for dog usage through trailhead signage and maps. The goal is to encourage skiers with dogs to utilize the County Line or Ward trails which have fewer steep hills and longer site-distance which provides safer conditions for being on trails with dogs. **To limit dog accidents and attacks, the GMNC needs USFS approval to keep dog skiers off the Skyway trail system. Specific trail signs restricting skiers with dogs at Skyway would be a good first step in eliminating any conflicts.**

Parking

Expand parking availability and improve safety in parking areas

GMNC Parking Goals:

1. Continue a dialog with USFS representatives to encourage **evaluation** of the parking capacity and consider moving and expanding the Ward trail parking area.
2. Parking at the Ward Lake trailhead is limited to 25 vehicles, and is located within the Highway 65 right-of-way. This style of parking lot has been proven dangerous, even fatal, as unfortunately experienced at County Line in years past. Evaluate options for moving the parking at this trailhead and recommend the expansion to the USFS. This study should be part of the bigger plan to include upgrading the Ward Lake ski trails.
3. Parking at Skyway trailhead will soon reach capacity. This is in spite of a Forest Service Capital Improvement Project (CIP) completed in 2018 that added capacity and restroom services. There are few and infrequent opportunities to invest in new CIPs.

www.GMNC.org / grandmesanordic@gmail.com

Business Office: PO Box 4034, Grand Junction CO 81501

Grooming Equipment:

A sufficient inventory of well-maintained grooming equipment is fundamental to achieving the GMNC mission.

GMNC Equipment Goals:

1. Properly maintain all equipment for a longer useful life and to minimize breakdowns while in use. The Operations Manager shall be responsible for ensuring equipment is properly maintained, equipment maintenance logs are kept up to date, and old or unneeded equipment is properly disposed of. Ensure back-up equipment is available so that grooming can almost always be accomplished the day needed. Post season, all equipment needs to be evaluated and prepared for off-season storage.
2. Ward Lake requires one main snowmobile, one roller, one Ginzu Groomer™, one grader, and associated fuel cans, hand tools and shovels, stored at the campground near the Visitor Center when not in use.
3. Skyway/County Line grooming requires two snowmobiles, one roller, two Ginzu Groomers™, one grader, and associated fuel cans, hand tools and shovels. The Pisten Bully snowcat shall be based at Skyway where it can easily connect to the County Line trails, allowing for contiguous grooming of both trail systems from a single staging area.
Proposed: Construct a USFS-approved snowcat/snowmobile storage shelter with possible electrical service to allow for heated parking and maintenance. The design is flexible but would need to fit the snowcat and two snowmobiles with sliding doors for ease of entrance and exit.

Snowcat Capital Replacement Fund:

With the acquisition of the PistenBully 400 in 2017, the GMNC has identified the need to put funds aside to replace the snowcat in a 15-20 year time frame.

GMNC Capital Fund Goal:

1. Consistently add to the GMNC's capital fund for major expenses. The capital fund will be used to replace grooming machinery, snowcat, snowmobile grooming equipment, building an equipment shed, and adding electrical power.

Signs and Maps:

Create a signage plan that reflects the high-quality trail experience that is being offered on the Grand Mesa. Signs should be consistent across all three trail systems.

GMNC Signs and Maps Goals:

1. Construct simple, durable, easy-to-understand intersection signage. Signs are more important for newer trail users.
2. The addition of on-trail signage is intended to encourage responsible trail use for skiers with dogs and to discourage skiing with dogs on trails where dogs are a safety concern.
3. Submit new signs to USFS for approval prior to deployment.
4. Revise trail maps when changes have been made, usually every two seasons. Website maps are to be updated when any changes are made.

www.GMNC.org / grandmesanordic@gmail.com

Business Office: PO Box 4034, Grand Junction CO 81501

GMNC USFS Permits Goal:

- Maintain the current Ski Area Permit and Annual Operating Plan. Annually review and update the Operating Plan to match the goals of this Master Development Plan.

Trail Facilities:

Currently, GMNC maintains a seasonal, soft-sided warming hut at Skyway which provides an element of protection from the harsh winter environment of the Grand Mesa.



The current GMNC warming hut at Skyway trailhead.



The warming hut is a social center for the Nordic ski community, providing a sheltered place for lunches, lessons, and activity planning.

GMNC Trail Facilities Goals:

1. In 2020, GMNC is pursuing a permanent warming hut at Skyway. Funding will be provided by a private donor. The addition of a permanent structure will be open to the public with an improved setting to relax after skiing, eat lunch, and warm-up before or after skiing. The proposed building will have dimensions close to 20 ft x 30 ft that would accommodate up to 30 people, assuming no social distancing.
2. A design offered by Frontier Log Homes is being considered, similar in style to the bathroom at the Grand Mesa Visitor Center. The log cabin structure will be compliant with Mesa County Building Department and US Forest Service design standards. See design shown in **Exhibit C**.
3. As described in the Current Trends section above, the Skyway and County Line trail systems have evolved to become one of the most popular Nordic ski systems in western

Colorado. It is not uncommon to see parking lots at both trail systems at capacity on weekends. Estimates, based on vehicle counts, have reached 30,000 skiers per season.

4. As a result of the increased popularity of cross-country skiing and snowshoeing on Grand Mesa, we request for approval of additional trails at Skyway and County Line.

See **EXHIBIT D** for a proposed new ungroomed snowshoe trail.

Proposed Maintenance Shed:

1. GMNC also has a vision of an equipment parking/maintenance shed to provide a heated space to service grooming equipment. Storing snowmobiles in the heated garage would reduce mechanical problems with grooming equipment, and allow staff to spend more time grooming as opposed to working on equipment.
 2. If a new permanent warming hut is approved and constructed at Skyway, the existing moveable hut would be moved to the County Line trailhead to provide shelter for trail users there.
-

Proposed Lodge at County Line:

In our long-term vision, County Line offers a central location for a permanent lodge for GMNC operations. The County line landscape offers more possibilities for a practice area for lessons and clinics. The lodge design is dependent on several currently unknown factors. Having a permanent warming hut at both Skyway and County Line would support increasing skier use on the entire trail system. The moveable hut could then be moved to Ward, or used as a destination hut elsewhere on the trail systems.

GMNC Proposed Lodge Goals:

1. Design and plan a suitable lodge for County Line, to be constructed after the Skyway building is complete.
2. Satisfy the needs of the GMNC membership with a solar powered, highly functioning building, space for events, space for first aid and supplies, tool shed, decking, etc. making this a central location for Grand Mesa skiers. The hut would be open to the public, and perhaps serving as a summer cycling center.
3. A lodge fundraising campaign and increased public awareness.

www.GMNC.org / grandmesanordic@gmail.com

Business Office: PO Box 4034, Grand Junction CO 81501

GMNC GOALS AND PRIORITIES

Priority	DESCRIPTION
1	Race Programs: Continue the long-standing tradition of a citizen race program with at least four races per season, open to all levels of skiers in a friendly, competitive spirit.
1	Ski Lessons: Continue to offer group and individual ski instruction for ski community maturity and growth.
1	Kid's Program: Revive a kid's program run through the GMNC that emphasizes skills and fun competition and works with the surrounding communities to introduce a healthy, lifelong sport to kids.
1	College Race Event: Revive a college race event in partnership with the Colorado Mesa University Nordic ski team. A component of this event will be open to citizen racers. GMNC support for the local university team.
1	Snowshoe trails: Similar to the existing ungroomed snowshoe trail at Skyway, create and sign an ungroomed snowshoe loop at County Line. Also create and sign an ungroomed trail connecting County Line to Skyway without crossing any of the ski trails, but following existing roads. This would be a single-track adventure trail for snowshoers and would reduce user conflict, ski-trail traffic, and ski-trail damage.
1	Dogs: Additional on-trail signage intended to encourage responsible trail use for skiers and snowshoers with dogs. Per skiers consensus, skiers with dogs will be encouraged to use the trails at County Line and Ward. USFS support for better signage at Skyway. New signs must be approved by the USFS prior to posting.
1	Reduce Conflicts With Snowmobile Users: Improve signage along the snowmobile corridor, along Skinned Horse trail at Ward, and other known snowmobile access points to curtail intrusion within the ski area pods. Ward system will require coordination with USFS/lodges near Upper Ward Lake.
2	Equipment Shed: Construction of equipment shed for parking and maintenance of grooming equipment, at either Skyway or County Line. Include a solar-powered electrical system for power, lights/heating.
2	Under Board consideration- Permanent warming hut at Skyway: Utilize donations from members to construct a log cabin style (20'x30) structure to accommodate skiers and centralize activities and events such as races and lessons.

2	Under Board consideration- Install Solar Power: Solar Power for permanent building and equipment shed at Skyway.
2	Under Board Consideration- Move existing warming hut from Skyway to County Line. Upon approval and construction of permanent warming hut, move the existing soft-sided hut to near the County Line trailhead.
2	Summit trail: To accommodate the PistenBully-400, widen the existing trail by 6-8 feet to allow for more efficient grooming and to minimize the need to backtrack during grooming operations.
3	New Trails for Races at Skyway: Design and construct small, stacked loops off the intersection of Arroyo and Scales Lake Road trails, connecting to other existing trails, for races and other events close to the trailhead. This would allow for continued public use during races, easy preparation for races, and would be spectator friendly.
3	Ward Lake Parking: Evaluate the need for moving the existing parking area at lower Ward to a central, off-highway parking area that would safely accommodate a growing ski population. The upper parking area would then be abandoned.

EXHIBITS

EXHIBIT-A: Skyway & County Line TRAIL MAP

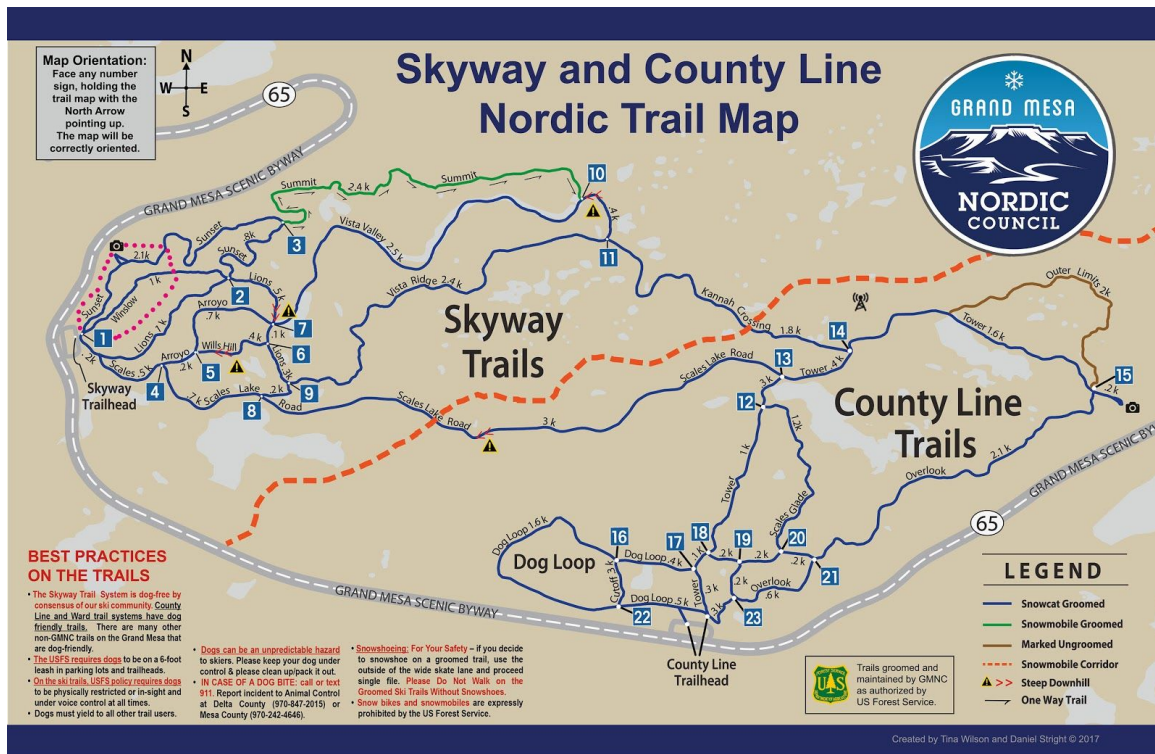
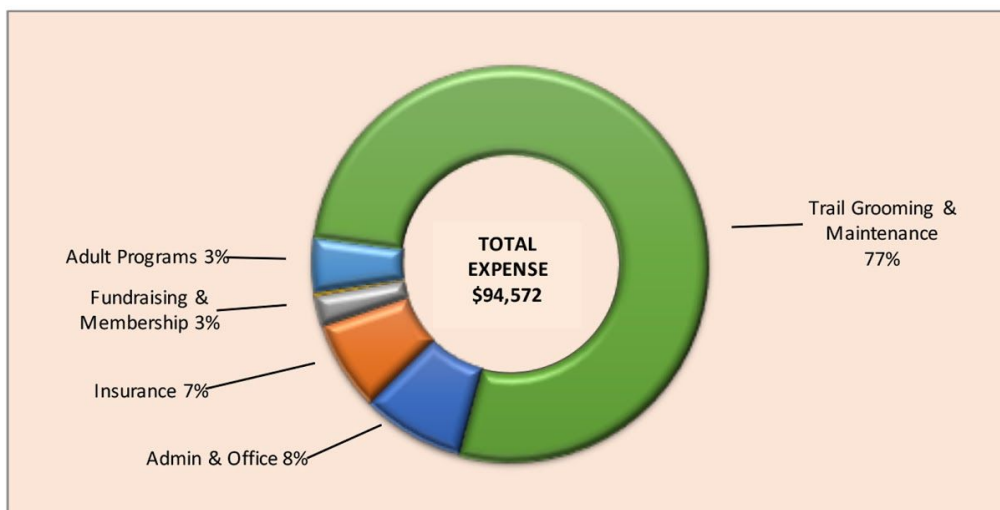
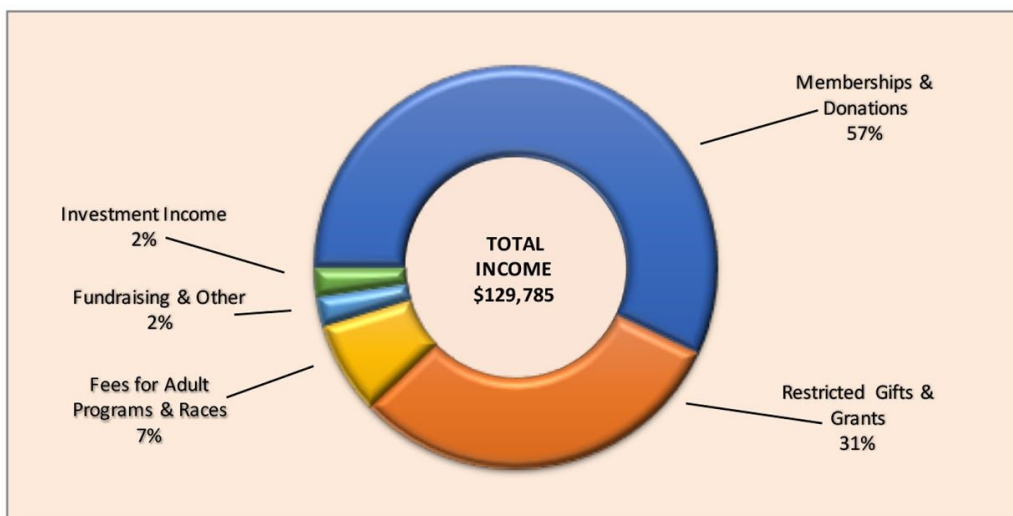

EXHIBIT-A: Ward TRAIL MAP



EXHIBIT-B: Annual Budget & Expenditures

GMNC Financials from 2019 Federal Return for Tax Exempt Organization



In 2020, in spite of an early end to the grooming season due to COVID-19, GMNC's overall contributions were similar to the previous season's contributions. Mesa County and Delta County both awarded generous grants. The Goodwin Foundation awarded a grant to cover the full cost for a new snowmobile grooming machine. Overall expenses were also on par with the previous season. GMNC's financial position remains strong. This allowed its Board of Directors to develop its capital fund for future investments in new grooming equipment and infrastructure. Next season membership dollars will be hard at work grooming GMNC trails.

www.GMNC.org / grandmesanordic@gmail.com

Business Office: PO Box 4034, Grand Junction CO 81501

EXHIBIT-C: Proposed Skyway Hut - Hut will be compliant with Mesa County Building Department and Forest Service design standards.

Frontier Log Homes

- Local Log Structure Construction Company (Montrose)
- Have completed projects locally for US Forest Service and National Park Service
 - Black Canyon NP Visitor's Center
 - Grand Mesa Visitor's Center
- Will act as general contractor. May be prequalified with US Forest Service.
- Will design to client's specifications

Benefactor Design Criteria for Skyway Warming Hut

- ☐ Skyway trailhead
- ☐ Single purpose structure
- ☐ Day-use warming lodge where Nordic skiers can gather
- ☐ Building closed and well-secured at night and during the off-season
- ☐ Single story
- ☐ Does not incorporate attached garage for grooming equipment

www.GMNC.org / grandmesanordic@gmail.com

Business Office: PO Box 4034, Grand Junction CO 81501

EXHIBIT-C: Proposed Skyway Hut

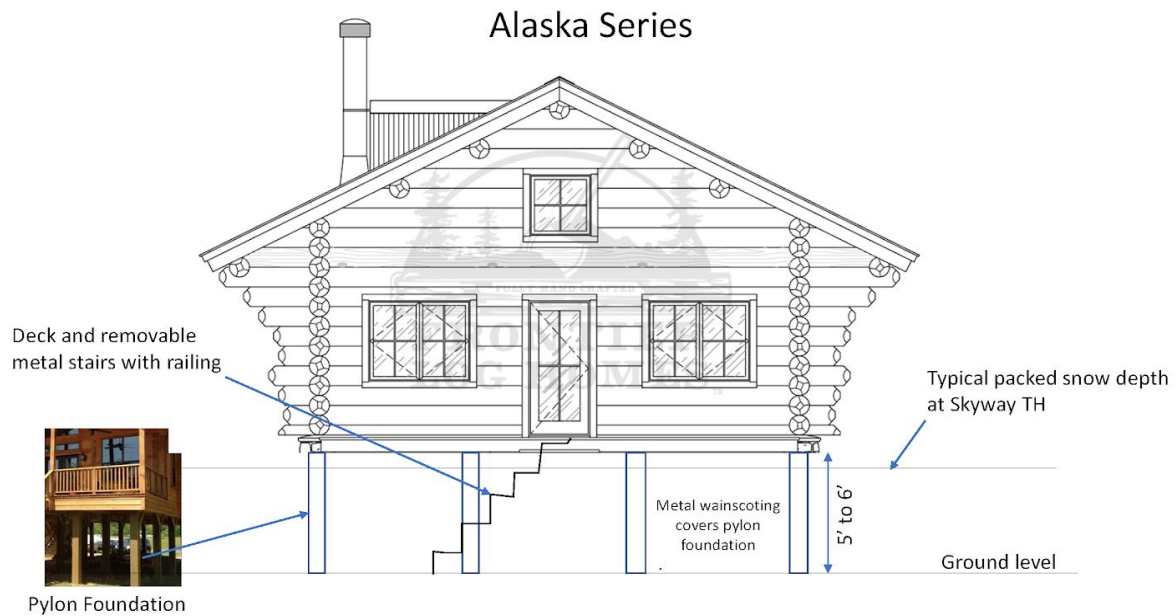
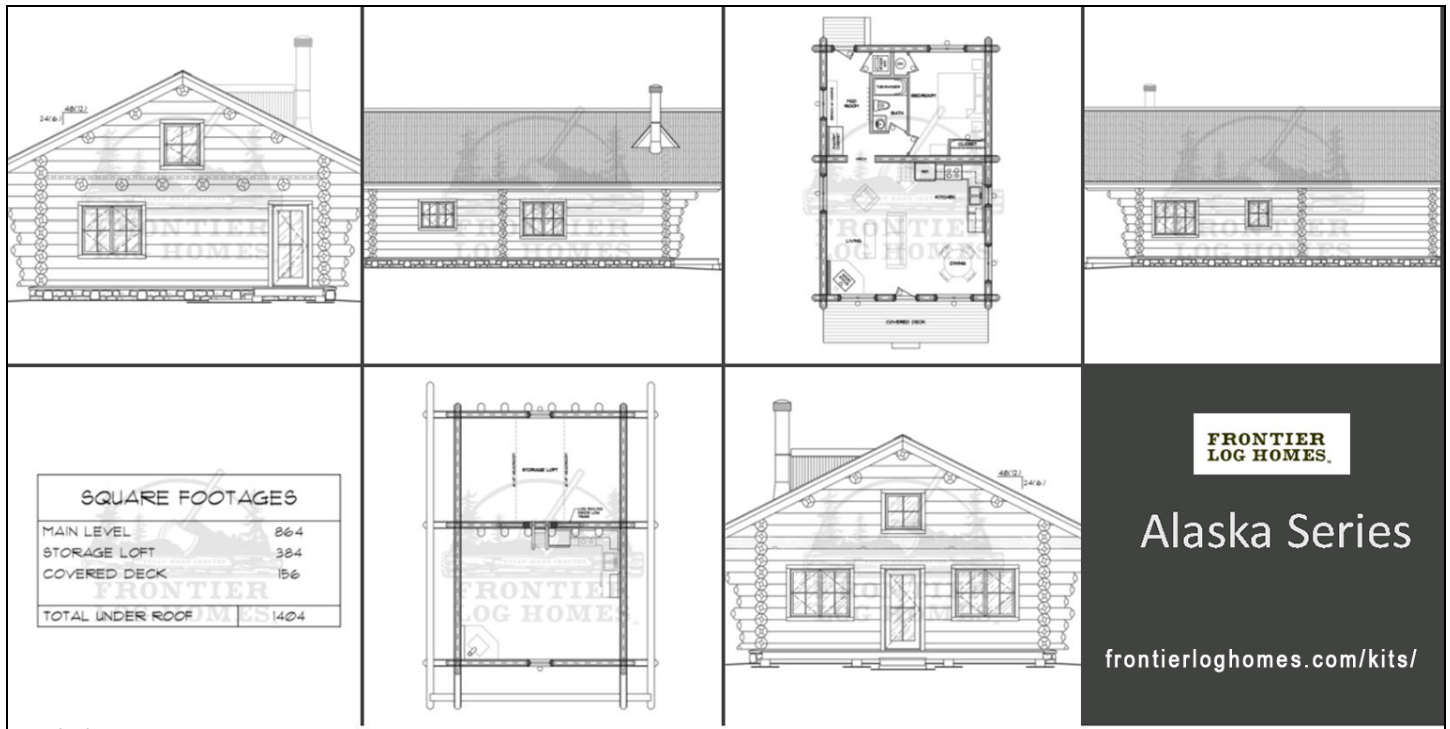

Frontier recommends use of pylons to elevate floor above ground level for off-season security - removable metal stairway is stowed in off-season. Also economical and protects structure from snow.

EXHIBIT-C: Proposed Skyway Hut

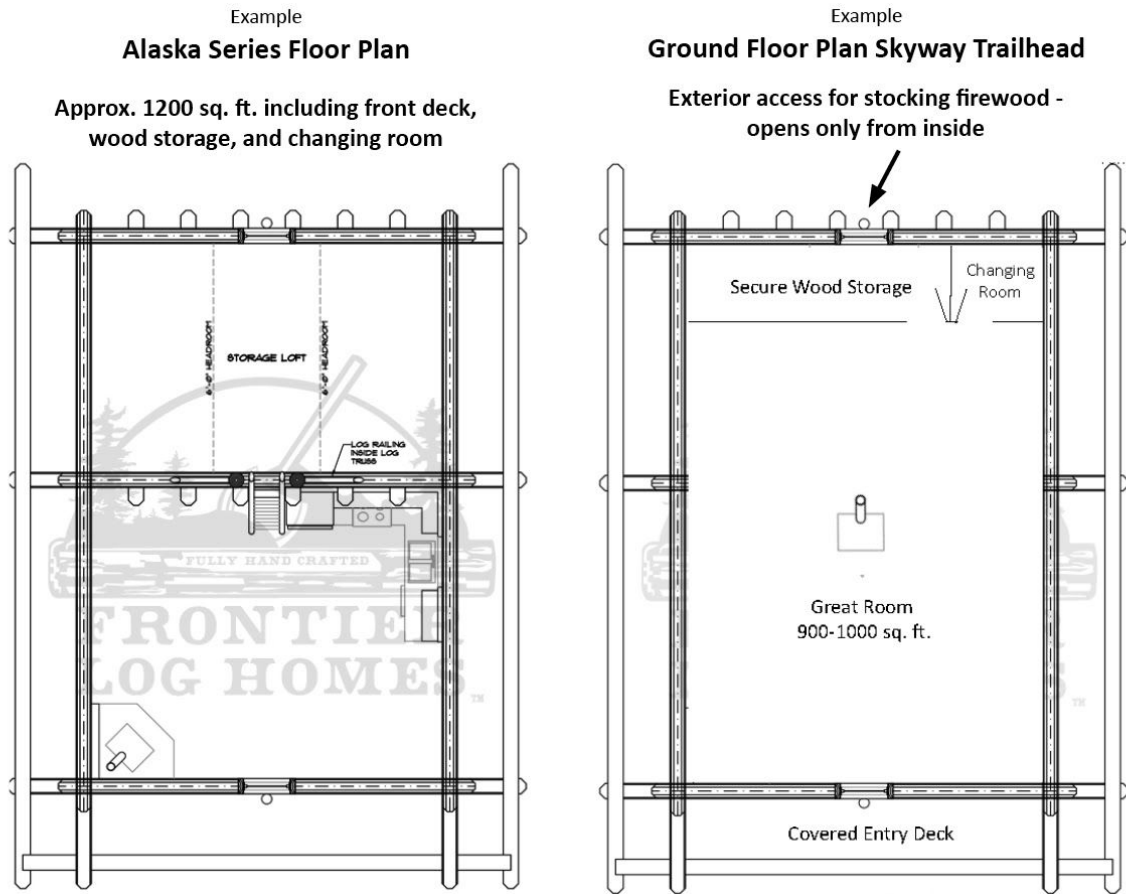

Frontier Log Homes Alaska Series – Preliminary Cost Estimate

Base Structure – Approximately \$100/ft²

- ☐ All the logs needed for walls and roof structure
- ☐ Freight to building site
- ☐ On-Site Assembly by FLH Professionals
- ☐ Log bucks to frame out the doors and windows
- ☐ Log stairs and log railing

Additional Costs* – Up to an additional \$100/ft²

- ☐ Windows, Doors, Subflooring, Roofing, Roof and Floor Insulation, Wainscoting
- ☐ Earth Work - Assumed minimal with Pylon foundation
- ☐ Foundation - Pylon and beam (recommended for security and snow management)
- ☐ Finish Materials - (wood storage, changing room, metal stairs for deck)
- ☐ Woodstove & Fixtures (tables, benches - GMNC)
- ☐ Window and Door Security

**Frontier could be General Contractor for these tasks*

GMNC responsibility

- ☐ Permitting, USFS approval, and NEPA Analysis
- ☐ Consider cost sharing a portion of project from Board-Designated Infrastructure Fund (\$52,000 available)

www.GMNC.org / grandmesanordic@gmail.com

Business Office: PO Box 4034, Grand Junction CO 81501

EXHIBIT-D: Proposed Snowshoe Trail – Connecting Skyway and County Line

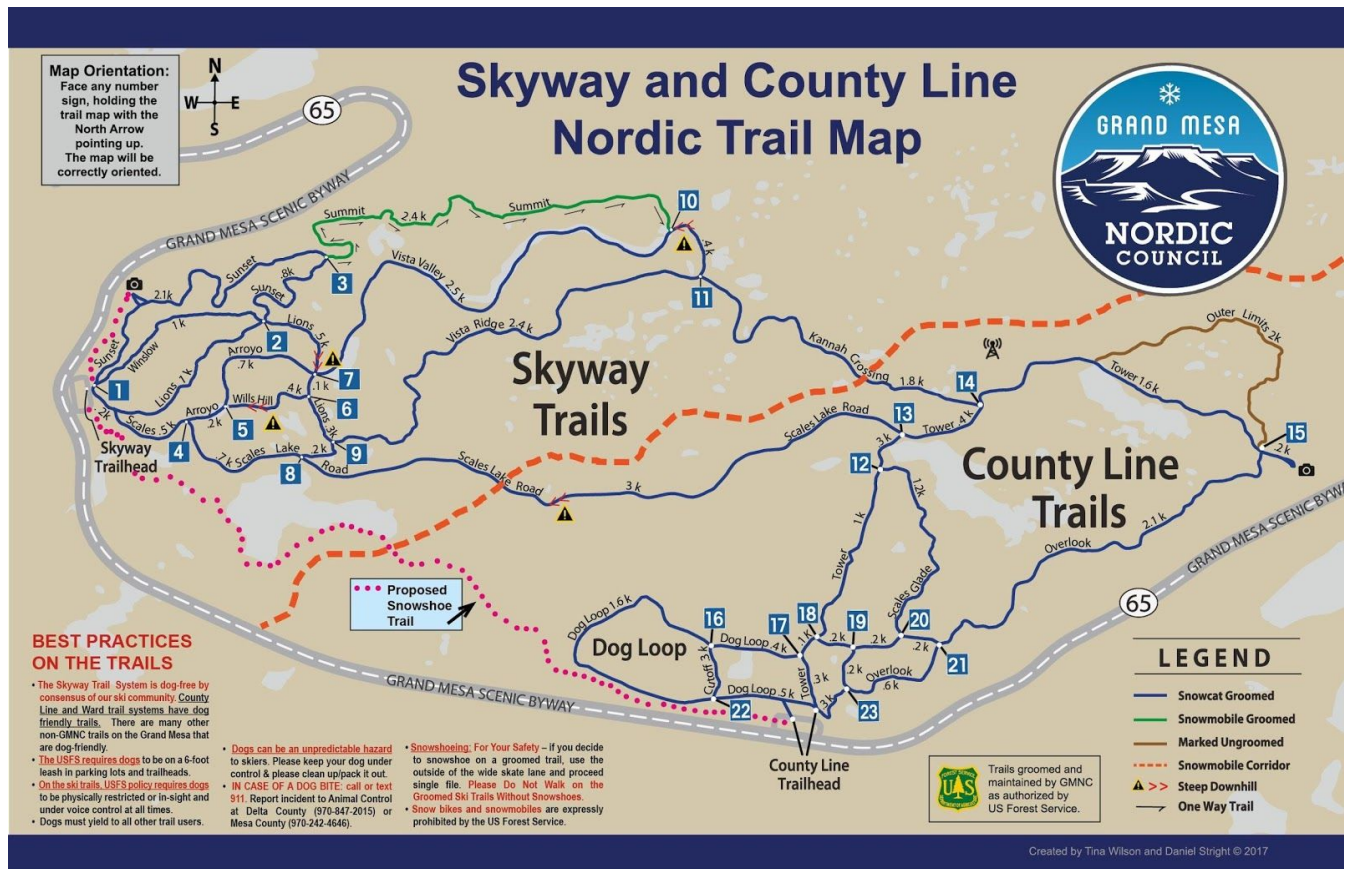

www.GMNC.org / grandmesanordic@gmail.com

Business Office: PO Box 4034, Grand Junction CO 81501